



Alameda Corridor-East Construction Authority

4900 Rivergrade Rd. Ste. A120 Irwindale, CA 91706 (626) 962-9292 fax (626) 472-0094 www.theaceproject.org

****CONSTRUCTION ALERT****

NOGALES STREET TO CLOSE ON MARCH 22 FOR 24 MONTHS

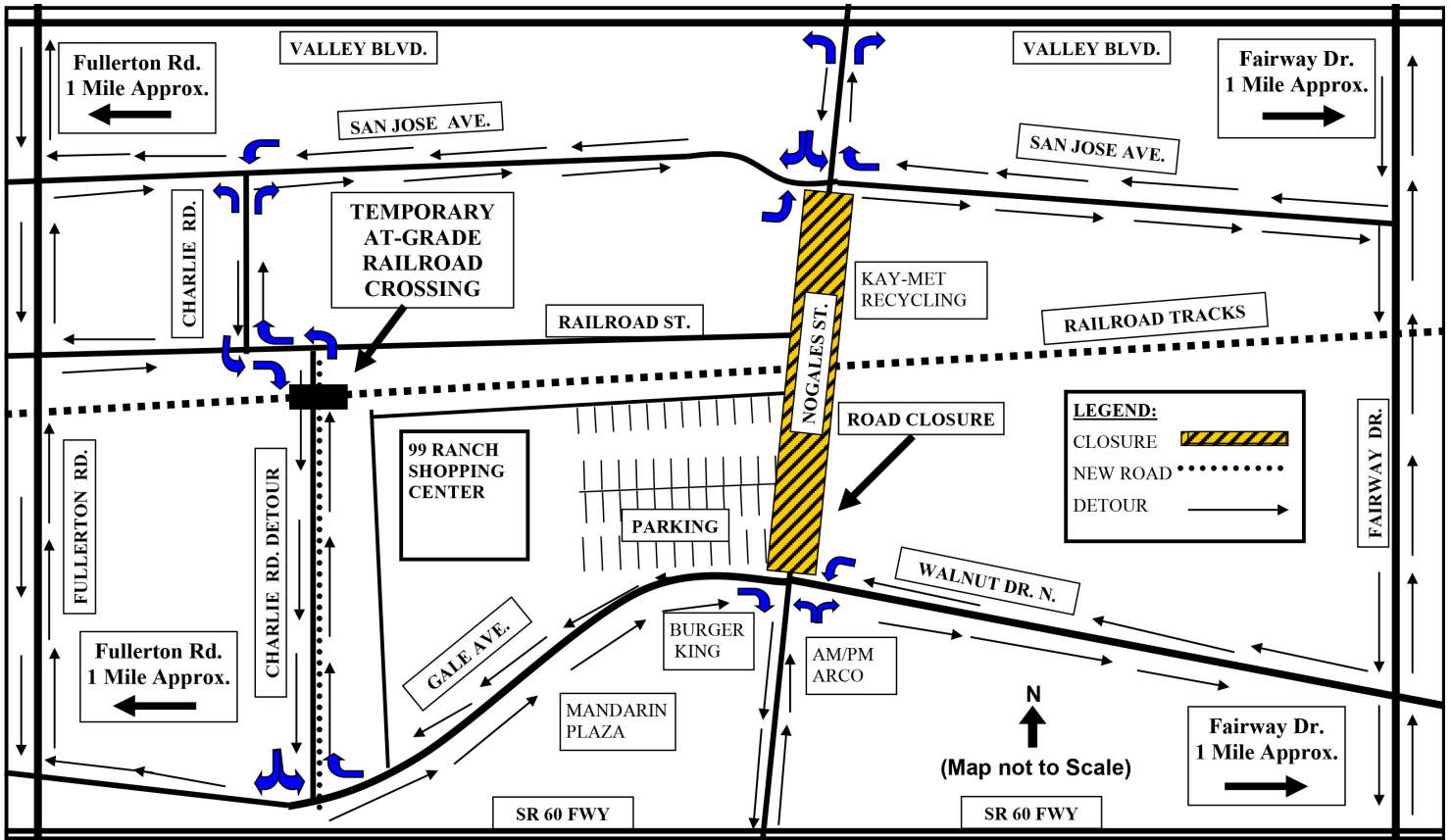

WHAT

The Alameda Corridor-East Construction Authority (ACE) will close Nogales Street from San Jose Avenue to Gale Avenue/Walnut Drive North to construct a six-lane roadway underpass and double-track railway bridge for the Nogales Street Grade Separation Project in the City of Industry and unincorporated community of Rowland Heights. Upon completion, traffic congestion, potential collisions with trains and noise from train horns will be eliminated.

WHEN

Nogales Street is scheduled to be closed for construction on or after **Saturday, March 22, 2014** for up to 24 months. Most work will take place on weekdays between 7 a.m. and 5 p.m.

WHAT TO EXPECT

Local access to businesses will be maintained. A detour route with temporary rail crossing at Charlie Road Detour will be opened to allow local north-south traffic to reconnect with Nogales Street (see map above). Motorists and pedestrians are encouraged to use Fullerton Road and Fairway Drive as major north-south detour routes. Noise, dust and vibration will be monitored for compliance within applicable limits.

Para información o preguntas, por favor llame el teléfono directo o visite el sitio web en:

如有疑問或需要索取工程最新資料, 請致電輔助熱線或參閱工程網頁

For the most up-to-date information or questions, please call or visit:

(888) ACE-1426 or www.theaceproject.org

Thank you for your patience and cooperation...At ACE, it's Safety First!